

8.250

98.550

98.950

boundary to be  
line true extents

+Ex 100.00 Apx.

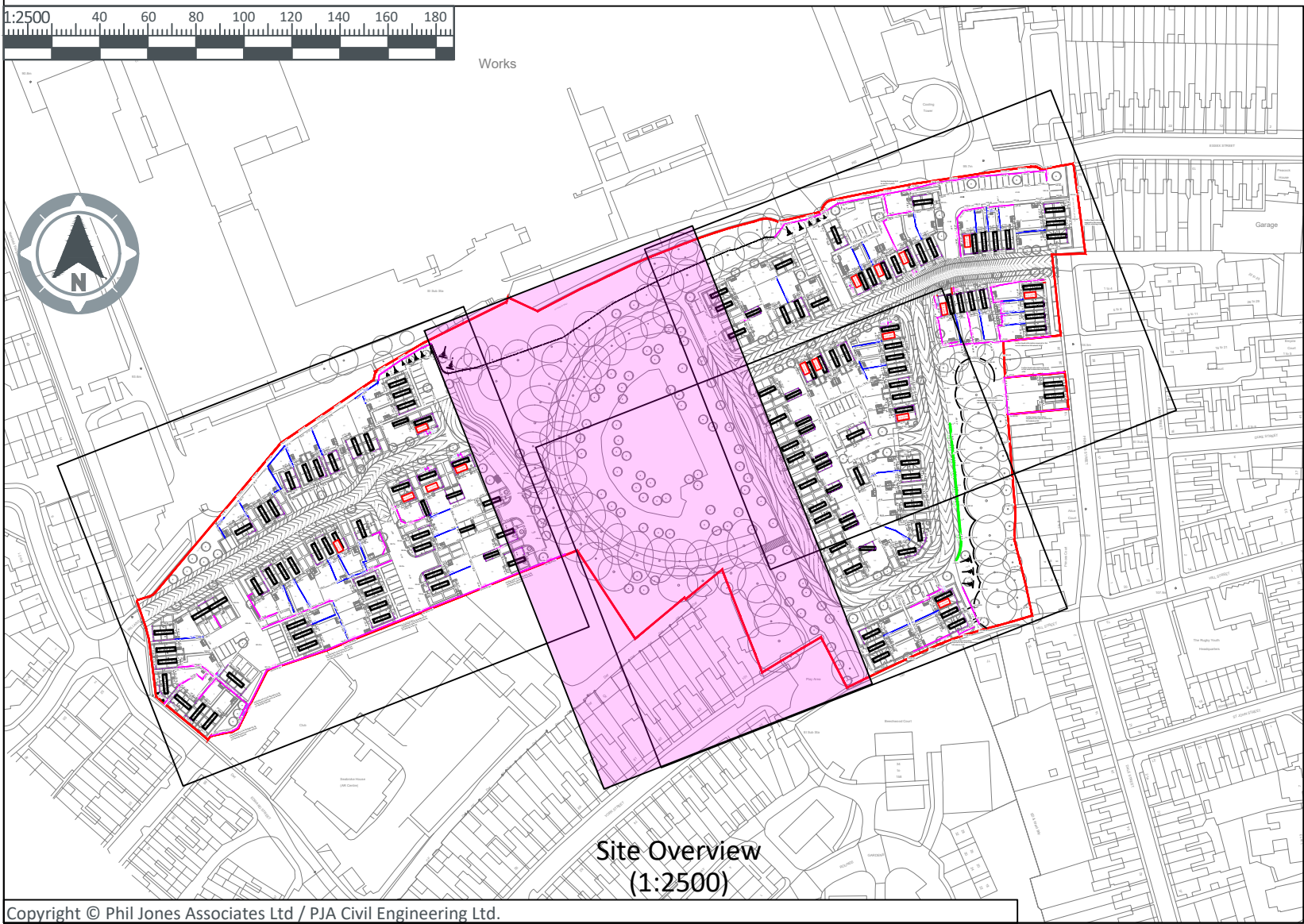
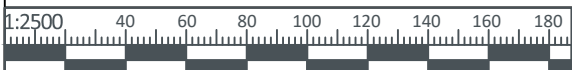

Copyright © Phil Jones Associates Ltd / PJA Civil Engineering Ltd.

CDM Note

These drawings have been produced with reference to the CDM Regulations 2015. Please note that these are pre-construction phase drawings and should be subject to further design risk management as required in accordance with Regulation 9.

**GENERAL NOTES:**

- This drawing is to be read in conjunction with all other relevant Engineering and Architect's details.
- The design details presented must be reviewed in conjunction with the wider site information and site constraints which may not be evident on drawing and must be requested if not already provided. This includes, but not limited to, ground conditions (geotechnical and geo-environmental), groundwater levels, buried services, remnant obstructions, ecology, tree protection and topography.
- The Engineer shall be notified immediately, in writing, should any errors or discrepancies be found prior to the commencement or continuation of any works.
- All work is to be carried out in accordance with current British Standards, Building Regulations and NHBC Standards.
- It is the responsibility of the Contractor to execute the works at all times in strict accordance with the requirements of the Health and Safety at Work Act 1974, and the C.D.M. Regulations 2015. The Contractor will be deemed to have allowed for full compliance, including full liaison with the CDM Co-ordinator, within his rates.
- Any existing details which are shown on this drawing are for guidance only and are to be checked on site by the contractor. Any variations are to be recorded and reported to the engineer immediately.
- Before work commences contractor should consult the engineer and the SI report regarding any contamination issues. All necessary Health and Safety measures to be taken

**KEY**

- Site Boundary
- Proposed Level
- Proposed Finished Floor Level
- Brickwork Tanking
- Brickwork Exposed
- Double DPC
- Retaining Feature
- Gravel Board Retention
- Log Retention
- Steps

**PRELIMINARY SCHEME**  
For comment and review only.  
Design is based upon information available at the time.  
Design is subject to full review as additional information becomes available.  
Design is subject to full review upon receipt of comments from

- Development Control
- LA Planning Authority
- Environment Agency
- LA Highways Department
- Sewerage Undertaker

All FLL's subject to +/-600mm detailed design variation

P4	14.06.2024	ISSUED FOR PLANNING.	SWJ	DMcCDMcC
P3	04.06.2024	DRAFT ISSUE FOR COMMENT.	SWJ	DMcCDMcC
P2	03.06.2024	UPDATED TO SUIT LATEST LAYOUT.	SWJ	DMcCDMcC
P1	31.01.2024	10689-2200 R9112-RLA-23-XX-DR-A-2200 P14 Proposed Site Plan	JP	MS MS
P0	26.01.2024	FIRST ISSUE	SWJ	DMcCDMcC
Rev	Date	Revision Note	Drw	Chk App

**PJA**

Park Point, High Street, Longbridge, Birmingham, B31 2UQ, UK  
T: +44 (0) 121 475 0234

transport • engineering • placemaking

Birmingham | Bristol | Cambridge | London | Manchester | Reading  
Melbourne | Perth  
pja.co.uk | pja.com.au

Client

St. Modwen Homes

Project

Land north of Rounds Gardens, Rugby

Title

External Levels  
(Sheet 2 of 4)

Drawing Issue Status

For Planning

PJA Ref	Scale @ A1	Date
05554/B	1:250	12.12.23
Drawing No.		Revision
R9112-PJA-23-XX-DR-C-0121		P4
Primary Contact	dan.mccruden@pja.co.uk	